

03

YSP-1, 2 Type Disc Steam Trap(Pipeline)

As a disc type trap, it effectively uses the difference in the thermodynamic characteristics between steam and condensate. It is appropriate for places where there is a high possibility of freezing damages, including where the outlet or a steam main is exposed to the atmosphere.

Features

- Economical Trap (YSP-1 : no need for a separate bypass pipeline & simple handle operation blows foreign substances out and discharges condensed water.)
- No air binding during the start-up & easy repair,
- Easy installation in a pipeline : compact product & either the screwed type or flanged type can be used according to installation conditions,



YSP-1 Type



YSP-2 Type

Specification

Type	YSP-1, YSP-2	
Applicable pressure	0.034~1.2MPa	
Fluid temperature	220°C below	
End connection	KS PT SCREW	
Materials	Body	GC200
	Disc, seat	STS
Hydraulic test pressure	1.8MPa	

▶ Install a strainer (80 MESH or more) at the front end when installing the valve.

Dimensions

(mm)

Type	Size	L	H1	H2	Weight (kg)
YSP-1 Type	15(½")	120	33	95	2.2
	20(¾")	125	33	95	2.2
	25(1")	135	37	97	2.8
YSP-2 Type	15(½")	80	33	84	1.6
	20(¾")	84	33	84	1.6
	25(1")	88	37	87	2.2

Dimensional drawing

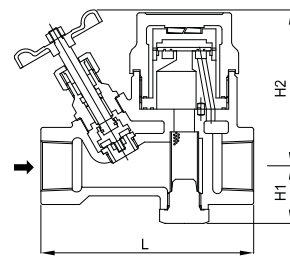

Type YSP-1
(Bypass valve attached)

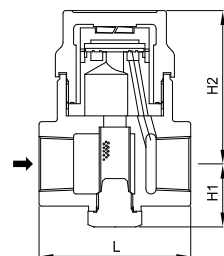

Type YSP-2

Flow curve

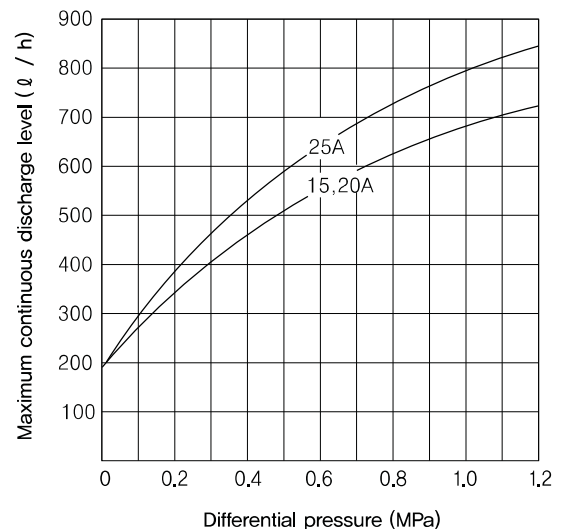

YSP-1 Type Steam Trap with Bypass

© Type YSP-1 Steam Trap with Bypass

03

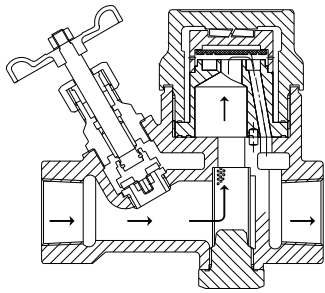

When the bypass valve is closed

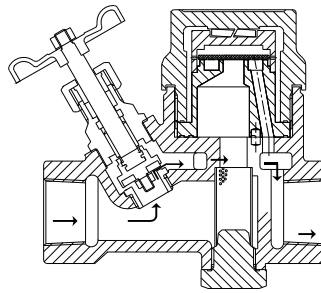

When the bypass valve is open

Features

- 2 different functions : (1) Trap—when the bypass valve is closed; (2) Condensed water discharge device—when the bypass valve is open.
- Built-in strainer.
- No need for a bypass pipeline.
- Simple structure : easy operation & repair.

Pipeline installation method

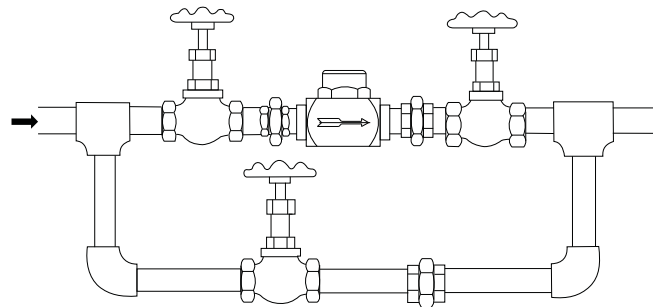

When a bypass steam trap is not attached

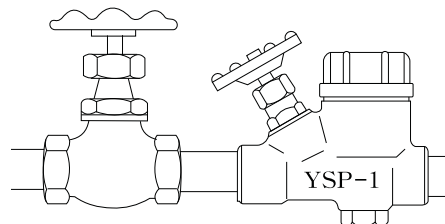

When a bypass steam trap is attached