

## Description

TL;DR: Sight Flow Indicator robust impeller (rotor) visual flow indicator for inline observation. Ideal for pump lines, process piping and level/flow verification — available in standard ANSI/DIN connections, multiple window materials, and explosion-proof lighting options.

## Key benefits

Clear inline visual verification with rotating impeller — immediate flow/condition check. Available with borosilicate, fused quartz (UV), or sapphire windows for high-temp / high-pressure service. Cast Iron housings (or Stainless steel 304 / 316) and ANSI/DIN flange or threaded connections. Low-maintenance impeller mechanism — replaceable cartridge options for serviceability. Optional explosion-proof LED lighting and cleaning wipes / purge ports.

## Technical Specifications

Model Sight Flow Indicator (impeller sight glass)

Parameter	Specification
Window material	Borosilicate glass (DIN7080) / Fused quartz / Sapphire glass (optional)
Housing	Cast Iron or (Stainless steel 304 / 316 on request)
Connection	Threaded BSP / NPT
Working pressure	Up to 40 bar (dependent on model/window thickness)
Operating temp.	-40°C to +300°C (higher temperature customizable)
Visible bore	Ø 20–150 mm (custom sizes on request)
Standards & certs	EN / DIN flange compatibility; material certificates (EN10204-3.1) on request

**Note:** allowable pressure & temperature depend on window material and thickness — supply operating pressure/temperature when requesting a quote.

## Applications

Pump discharge & suction lines (impeller action indicates flow direction & speed).  
 Process piping in chemical, food & beverage, pharmaceutical industries.  
 Boiler feed & condensate lines, filtration and slurry lines.

## Main Connection Dimensions

### Inner wire eccentric impeller viewing glass

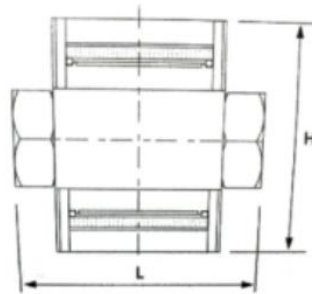

DN	External dimensions		Model
	L	H	
6	85	60	PGS-TEC-CIR-DN6
8	85	60	PGS-TEC-CIR-DN8
10	85	70	PGS-TEC-CIR-DN10
15	85	70	PGS-TEC-CIR-DN15
20	95	80	PGS-TEC-CIR-DN20
25	110	80	PGS-TEC-CIR-DN25
32	135	95	PGS-TEC-CIR-DN32
40	135	95	PGS-TEC-CIR-DN40
50	155	105	PGS-TEC-CIR-DN50

## Main Connection Dimensions

### Inner threaded straight-through impeller sight glass



DN	External dimensions		Model
	L	H	
10	100	70	PGS-TST-CIR-DN10
15	100	70	PGS-TST-CIR-DN15
20	100	70	PGS-TST-CIR-DN20
25	100	70	PGS-TST-CIR-DN25
32	120	80	PGS-TST-CIR-DN32
40	120	80	PGS-TST-CIR-DN40
50	150	100	PGS-TST-CIR-DN50