

inta

Check Valve & Filter

3085 & 3086

Installation and Maintenance Instructions



inta

Intatec Ltd
Airfield Industrial Estate
Hixon
Staffordshire
ST18 0PF

In this procedure document we have endeavoured to make the information as accurate as possible.
We cannot accept any responsibility should it be found that in any respect the information is inaccurate or incomplete or becomes so as a result of further developments or otherwise.

Tel: **01889 272 180**
Fax: **01889 272 181**
email: **sales@intatec.co.uk**
web: **www.intatec.co.uk**

Introduction

Inta supply a wide range of components for industrial, commercial and building service applications.

The Inta 3085 check valve with spring assisted closing and resilient seat can be used in a variety of orientations with the flow vertically upwards or horizontal.

The Inta 3086 filter can be fitted to the check valve inlet or to a pipe inlet for vertical applications, installed at the bottom of a tank to prevent the pump losing it's prime and to prevent larger piece of debris from entering the pump and system.

The check valve and filter are supplied as separate items.

These instructions cover the installation, operation and maintenance. Please read the enclosed instructions before commencing the installation of this product, please note;

We recommend that the installation of any Inta product is carried out by an approved installer.

It is recommended, especially in hard water areas, that a water softener such as the ActivFlo or ActivFlo lite be fitted to reduce the risk of calcium deposits forming.

Products

1" check valve	3085-101
1 ¼" check valve	3085-041
1 ½" check valve	3085-021
2" check valve	3085-201
1" filter for check valve	3086-101
1 ¼" filter for check valve	3086-041
1 ½" filter for check valve	3086-021
2" filter for check valve	3086-201

Technical Specification

Max. inlet pressure - static:	16 bar
Working temperature range:	0 to 90 °C
Medium:	Water
Threaded connections:	BS EN ISO 228

Dimensions

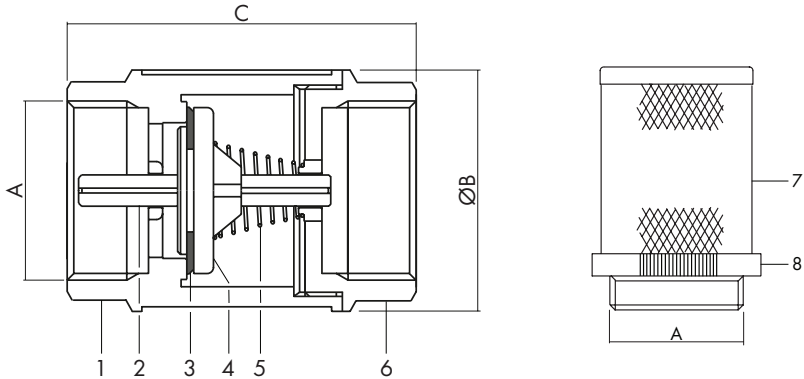

Code	A	B	C
3085-101	G1	53	82
3085-041	G1¼	65	87
3085-021	G1½	73.5	94.5
3085-101	G2	90.5	100

Code	A
3086-101	G1
3086-041	G1¼
3086-021	G1½
3086-101	G2

Material

Ref No	Component	Material
1	Body	Brass - CW617
2	Shutter	Polymer - PA6
3	Disc facing	NBR Elastomer
4	Disc	Polymer - PA6
5	Spring	St Steel - AISI 302
6	End Connection	Brass - CW617
7	Filter	St Steel - AISI 30L
8	Threaded fitting	Polymer Nylon 6.6

Installation

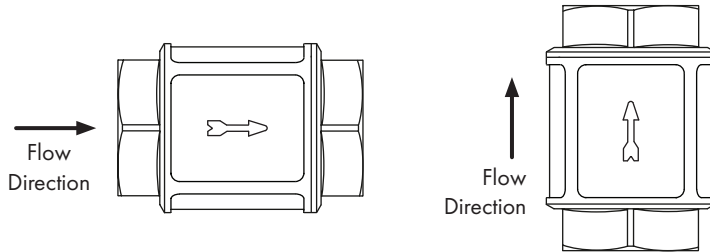

The check valve (in isolation) can be installed anywhere in the pipework provided that the flow is vertically upwards or horizontally.

The spring assisted closure enables the valve to be installed horizontally and prevent flow reversal.

Hand tighten the valve onto the inlet and outlet pipework and using the integral flow direction arrow check that the flow through the valve is in the correct direction.

Use a suitably sized spanner on the hexagonal sections to tighten the valve onto the pipework and make water tight joints.

The check valve can be connected to a filter and submerged at the bottom of a tank.

Tighten the filter onto the valve ensuring that is securely attached.

The outlet pipe connects the check valve to the pump to prevent the pump from loosing prime.

The spring enables rapid closure and the resilient seat gives good isolation with low back pressures.

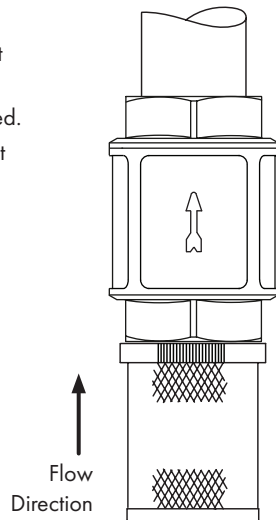

Maintenance

Very little maintenance is required for the check valve and the filter.

If the pump starts to lose its prime the unit should be removed from the tank, the check valve should be flushed with clean water and the valve examined for damage and debris, if in doubt the valve should be replaced.

If the flow becomes restricted check that the filter has not become blocked or that the mesh has not become blocked or damaged, replace as required.

Notes:

Notes:

inta

Please leave this Manual for the User

To activate your product warranty please visit

www.intatec.co.uk

and click on Product Registration

inta

Intatec Ltd

Airfield Industrial Estate

Hixon

Staffordshire

ST18 0PF

Tel: **01889 272 180**

Fax: **01889 272 181**

email: **sales@intatec.co.uk**

web: **www.intatec.co.uk**

E & O.E

© Intatec Ltd 2024

07-03-24